

St Johns Lane

BEDMINSTER

APPROXIMATE FLOOR AREA
95 SQM / 1023 SQFT



GROUND FLOOR
524 sq.ft. (48.7 sq.m.) approx.

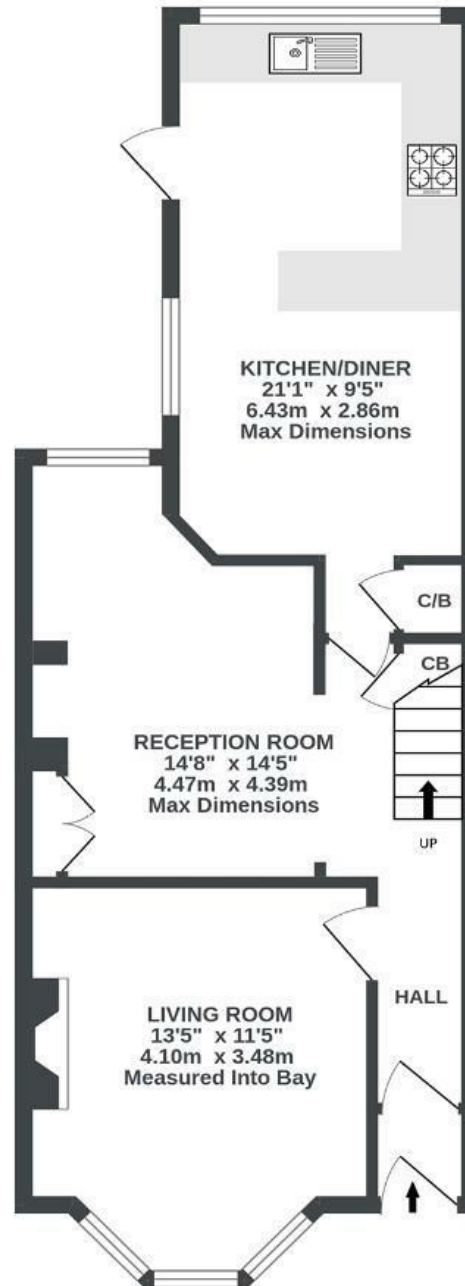

1ST FLOOR
499 sq.ft. (46.3 sq.m.) approx.

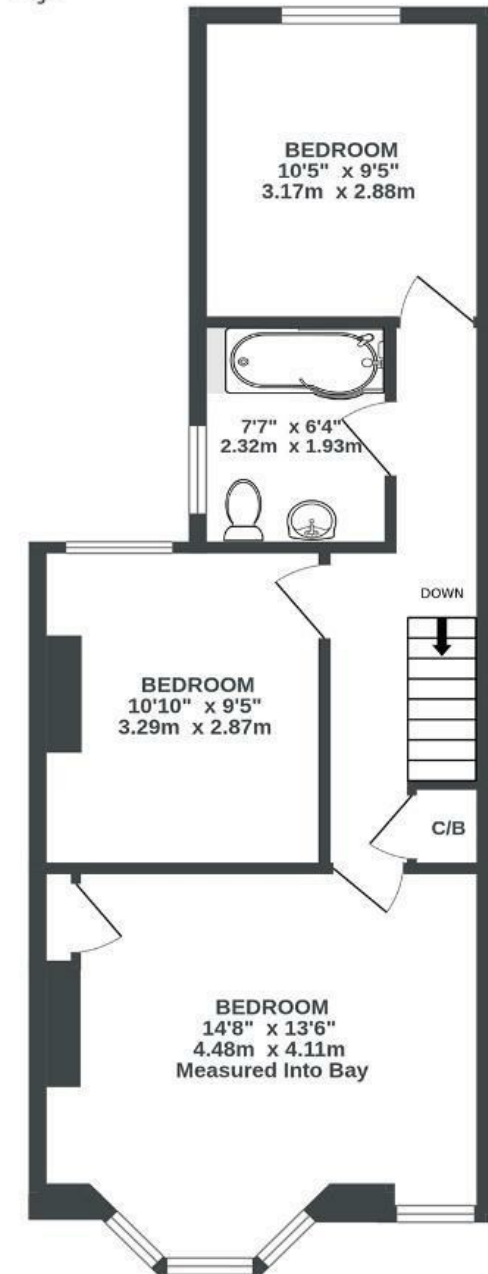

Illustrations are for reference purposes only, measurements are approximate, not to scale.

Boardwalk

St. Johns Lane

, BRISTOL



£425,000



3 Bedrooms



BS3 5AR



1 Bathrooms

"My wife and I bought this house as an investment, but we personally fell in love with it as soon as we saw it. The previous owners decorated it white and filled it with lots of joyous colours in artwork hung all around the house, and a design-oriented style, which really suited the house. This house has lots of original charm and is very peaceful and quiet - our previous tenants had all fallen in love with the house and were sad to leave when they were looking to move out of the area."

